

36 243 SD1 EUROPLUS E INFRA-RED ELECTRONIC BASIN MIXER 1/2"

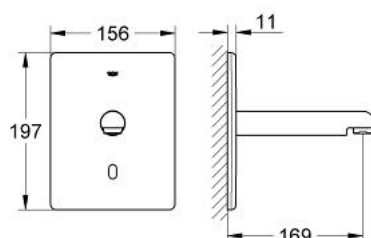

PRODUCT DESCRIPTION

- Colour: stainless steel
- with transformer 100-230 V AC, 50-60 Hz, 6 V DC
- set for final installation for concealed fitting box
- 36 009
- 36 241
- IR-electronic with detection in the handwashing area
- 7 pre-set programs:
- with 24/72 hours autoflush
- time or user dependent
- with cleaning mode
- safety stop after 60 sec.
- additional functions by remote control:
- adjustable flow time
- adjustable reflection range by remote
- activation of thermal disinfection for 3.5 or 11 min by hand
- stainless steel escutcheon
- stainless steel spout 169 mm
- laminar flow straightener 9 l/min
- type of protection IP 54
- noise classification I in accordance with DIN 4109
- CE approved
- GROHE Water Saving - Less water, perfect flow
- without concealed body

36 243 SD1 EUROPLUS E INFRA-RED ELECTRONIC BASIN MIXER 1/2"

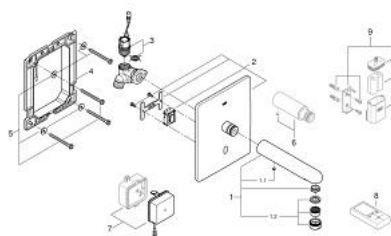

SPARE PARTS, 12月 2015 – now

1: Spout (Order-nr. 42121SD0)

1.1: Screw (Order-nr. 43094000)

1.2: Laminar flow straightener (Order-nr. 13960000)

2: Top plate (Order-nr. 42447SD0)

3: Solenoid valve (Order-nr. 42469000)

4: Mounting frame (Order-nr. 42736000)

5: Fixing set (Order-nr. 4308500M)

6: Outlet extension (Order-nr. 42126SD0)*

7: Switching power supply (Order-nr. 42470000)*

8: Remote control for all GROHE infra-red products (Order-nr. 36407000)*

9: Battery housing (Order-nr. 42393000)*

* Optional accessories