

36 244 000 EURODISC SE SELF-CLOSING SHOWER THERMOSTAT , 1/2"



PRODUCT DESCRIPTION

- Colour: chrome
- wall mounted
- 6V lithium battery, type CR-P2
- GROHE Long-Life finish
- GROHE TurboStat compact cartridge with wax thermoelement
- GROHE CoolTouchmetal housing
- temperature scale handle with safety stop between 35°C and 45°C
- non-return valve
- dirt strainers
- outlet above 3/4"
- start-stop function
- electronic controlled self-closing system
- Functions to activate with tip code:
 - flow time adjustable from 2 sec. to 30 min.
 - Automatic flushing: 5 min after 3 days without use
 - Thermal disinfection for 3,5 or 11 min
- CE approved
- noise classification 1 in accordance with DIN4109
- type of protection IP 69K (planned)
- minimum pressure 1,0 bar

36 244 000 EURODISC SE SELF-CLOSING SHOWER THERMOSTAT , 1/2"

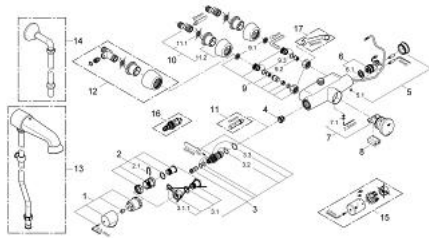

SPARE PARTS, June 2008 – now

- 1: Scale handle (Order-nr. 47409000)
- 2: Stop ring (Order-nr. 47641000)
- 2.1: Fixing clamp (Order-nr. 0574400M)
- 3: Thermo-element 1/2" (Order-nr. 47217000)
- 3.1: Stop ring + regulating nut (Order-nr. 47300000)
- 3.1.1: Fixing clamp (Order-nr. 0574400M)
- 3.2: O-ring $\varnothing 21 \times \varnothing 2$ (Order-nr. 0599900M)
- 3.3: O-ring $\varnothing 24 \times \varnothing 2$ (Order-nr. 0119600M)
- 4: Seat for thermostat (Order-nr. 01460000)
- 5: Shield (Order-nr. 43384000)
- 5.1: Screw dia. 4x52 mm (Order-nr. 4346200M)
- 6: Solenoid valve (Order-nr. 42323000)
- 6.1: Dirt Strainer (Order-nr. 42798000)
- 7: Cartridge (Order-nr. 43497000)
- 7.1: Screw dia. 4x52 mm (Order-nr. 4346200M)
- 8: Battery (Order-nr. 42886000)
- 9: Screw joint (Order-nr. 47643000)
- 9.1: Dirt Strainer (Order-nr. 0726400M)
- 9.2: Non-return valve (Order-nr. 08565000)
- 9.3: O-ring $\varnothing 17 \times \varnothing 2$ (Order-nr. 0305500M)
- 10: S-union (Order-nr. 12058000)
- 10.1: Ball seal dia. 9x6.8 mm (Order-nr. 0138600M)
- 10.2: Covering escutcheon (Order-nr. 45545000)
- 11: Socket spanner (Order-nr. 19070000)*
- 12: S-union (Order-nr. 12051000)*
- 13: Headshower combination (Order-nr. 36248000)*
- 14: Elbow 1/2" (Order-nr. 12407000)*
- 15: Metal handle temperature control (Order-nr. 47763000)*
- 16: Thermoelement for changed waterways (Order-nr. 47657000)*
- 17: Special spanner (Order-nr. 19377000)*

* Optional accessories