

37 750 SD0 **TECTRON SKATE INFRA-RED ELECTRONIC FOR URINAL**



PRODUCT DESCRIPTION

- Colour: stainless steel
- set for final installation
- concealed installation
- CE approved
- infra-red control
- 6 V DC battery supply
- adjustable flow time
- 24 h flushing can be activated
- battery check lamps
- solenoid valve with dirt strainer
- front plate 156 x 197 mm
- without roughing-in set 37 006
- adjustable by infra-red control 36 206
- GROHE Water Saving - Less water, perfect flow



37 750 SD0 **TECTRON SKATE INFRA-RED ELECTRONIC FOR URINAL**

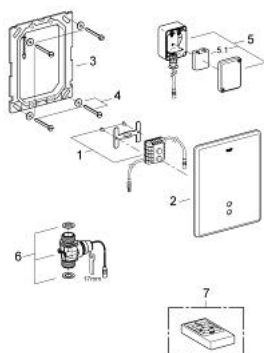

SPARE PARTS, May 2008 – now

- 1: Tectron electronic unit (Order-nr. 42188000)
- 2: Flush plate (Order-nr. 42191SD0)
- 3: Frame (Order-nr. 42736000)
- 4: Fixing set (Order-nr. 4308500M)
- 5: Battery housing with battery (Order-nr. 42741000)
- 5.1: Battery (Order-nr. 42886000)
- 6: Solenoid Valve (Order-nr. 42740000)
- 7: Infra-red remote control (Order-nr. 36206000)*

* Optional accessories