

## 37 753 000 UNISET FOR WALL-HUNG WC

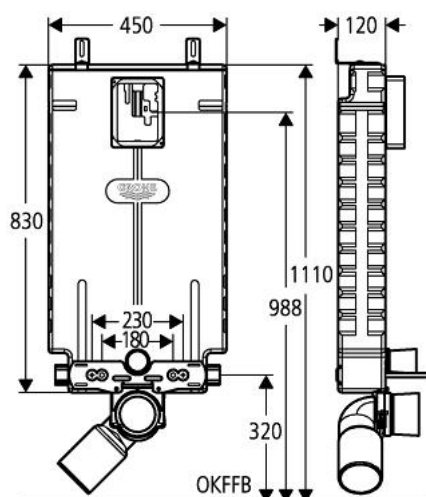

### PRODUCT DESCRIPTION

- dual flush cistern 6 l / 3
- sound-insulating EPS module for masonry-in with closed surface
- rail adaptors for modular fixing
- for single or series installation
- wall rail with fixing accessories for single installation
- 2 WC fixing bolts
- distance of fixing bolts 180/230 mm
- PP outlet bend Ø 80/100 mm
- inlet and outlet connecting set
- flushing cistern 6 l / 3 l
- pneumatic dual flush discharge valve
- low noise (group I acc. to German Noise Specification)
- insulated against condensation
- angle valve 1/2"
- without flush plate/actuation

## 37 753 000 UNISET FOR WALL-HUNG WC

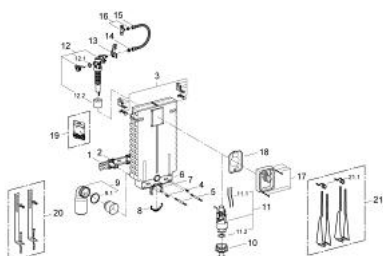

### SPARE PARTS, 1月 1999 – now

- 1: Protection cap (Order-nr. 43944000)
  - 2: Protective plate (Order-nr. 43552000)
  - 3: Support device (Order-nr. 43551000)
  - 4: Discharge valve, Dual Flush (Order-nr. 42774000)
  - 4.1: Tubes (Order-nr. 42775000)
  - 4.2: Seal for Dual Flush discharge valve (Order-nr. 4285200M)
  - 5: Compression nut (Order-nr. 43258000)
  - 6: Hose (Order-nr. 43349000)
  - 7: Filling valve (Order-nr. 43537000)
  - 7.1: Dummy plug and escutcheon cap (Order-nr. 37125000)
  - 7.2: Lever (Order-nr. 43734000)
  - 7.2.1: Seal (Order-nr. 4377000M)
  - 7.3: Valve head (Order-nr. 43536000)
  - 7.4: Membrane (Order-nr. 4375800M)
  - 7.5: Screw cap (Order-nr. 43735000)
  - 7.6: Valve float, 5 pcs. (Order-nr. 4379100M)
  - 7.7: Throttle (Order-nr. 42356000)
  - 7.8: Set of seals (Order-nr. 43722000)\*
  - 8: Angle valve (Order-nr. 42730000)
  - 9: Flush pipe, concealed (Order-nr. 43908000)
  - 9.1: Sealing washer (Order-nr. 4388000M)
  - 10: Valve seat for concealed cisterns, Dual Flush (Order-nr. 42773000)
  - 11: Set of seals (Order-nr. 43722000)
- \* Optional accessories