

38 784 SH0 **SKATE COSMOPOLITAN ACTUATION PLATE**

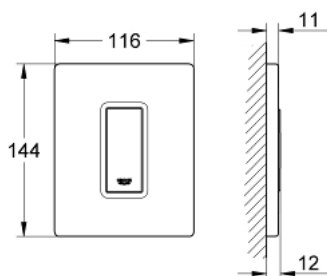

PRODUCT DESCRIPTION

- Colour: alpine white
- manual activation for urinal
- set for final installation
- for Rapido U or Rapido UMB
- 116 x 144 mm
- mechanical functional cartridge
- flow pressure min 0.5 bar
- operating pressure max 6 bar
- 1.0 - 6.0 l adjustable
- low noise (group II according to German noise specification)



38 784 SH0 **SKATE COSMOPOLITAN ACTUATION PLATE**

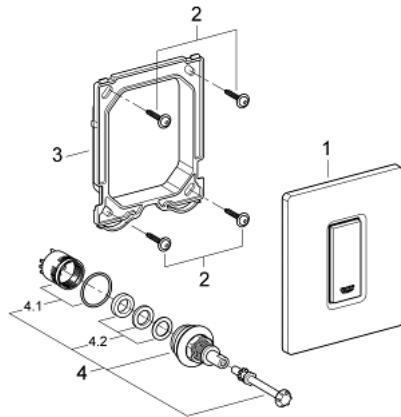

SPARE PARTS, 3月 2012 – now

1: Top plate with push button (Order-nr. 42377SH0)

2: Screw (Order-nr. 6636200M)

3: Mounting frame (Order-nr. 66845000)

4: Cartridge (Order-nr. 42354000)

4.1: Seal kit (Order-nr. 4271500M)

4.2: Rings (Order-nr. 4282000M)